

GREAT MEN LIVE ALIKE

Ultra-living for men of higher standing





Built with a sense of aesthetics.



The sky is the limit when we consider the design values that go into every home we ever create. Over the years, our architects and designers have continuously outdone themselves to offer our clients attractive homes that even a noble would be proud of.

Headquartered in Pune, KUL is involved in projects across Mumbai, Bengaluru and Panchgani-Mahabaleshwar. Led by the enigmatic Lalit Kumar Jain (Chairman), whose entrepreneurial skills are legendary, KUL has stamped its mark of excellence across the residential, commercial, retail and SEZ sectors. His vision of a truly world-class organization has been cast into fact, and his zeal for quality has been etched into stone.

Today, KUL is involved in 14 on-going projects across cities with an estimated area of 3.91 million sq. ft., with 73.13 million sq. ft. of space in 50 soon-to-be launched projects across the country. In a nutshell, our success story makes for a compelling tale.

Awards

- Top Ten Real Estate Companies in India
- Best Systems for an IT Park • Best Real Estate Company in Pune



ZRICKS.COM



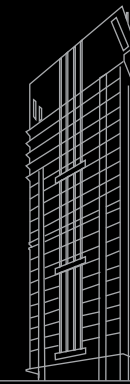

A bespoke lifestyle
for the discerning.



As the master of your destiny, it is your birth right to choose. And you chose to blaze your own trail rather than follow another's. It is no different when it comes to your lifestyle. You make your own statements wherever you go. That is precisely why, we have handcrafted a lifestyle that is worthy of your status and personality.



The pulse of the social elite in the heart of the city.



KUL Couture takes its rightful place in the galaxy of glittering developments. A dazzling monument to the elite, it shares the golden neighbourhood of Worli with world-class malls, exquisite restaurants, luxurious residences, the renowned Siddhivinayak Temple, and India's premium Mahalaxmi race course.

The neighbourhood is also home to some of the finest schools and colleges, so your children will never have to go far to receive a truly global education. KUL Couture is also well-connected to the Bandra-Worli Sea Link, with major business districts such as Bandra-Kurla Complex, Prabhadevi, Lower Parel and Nariman Point easily accessible.

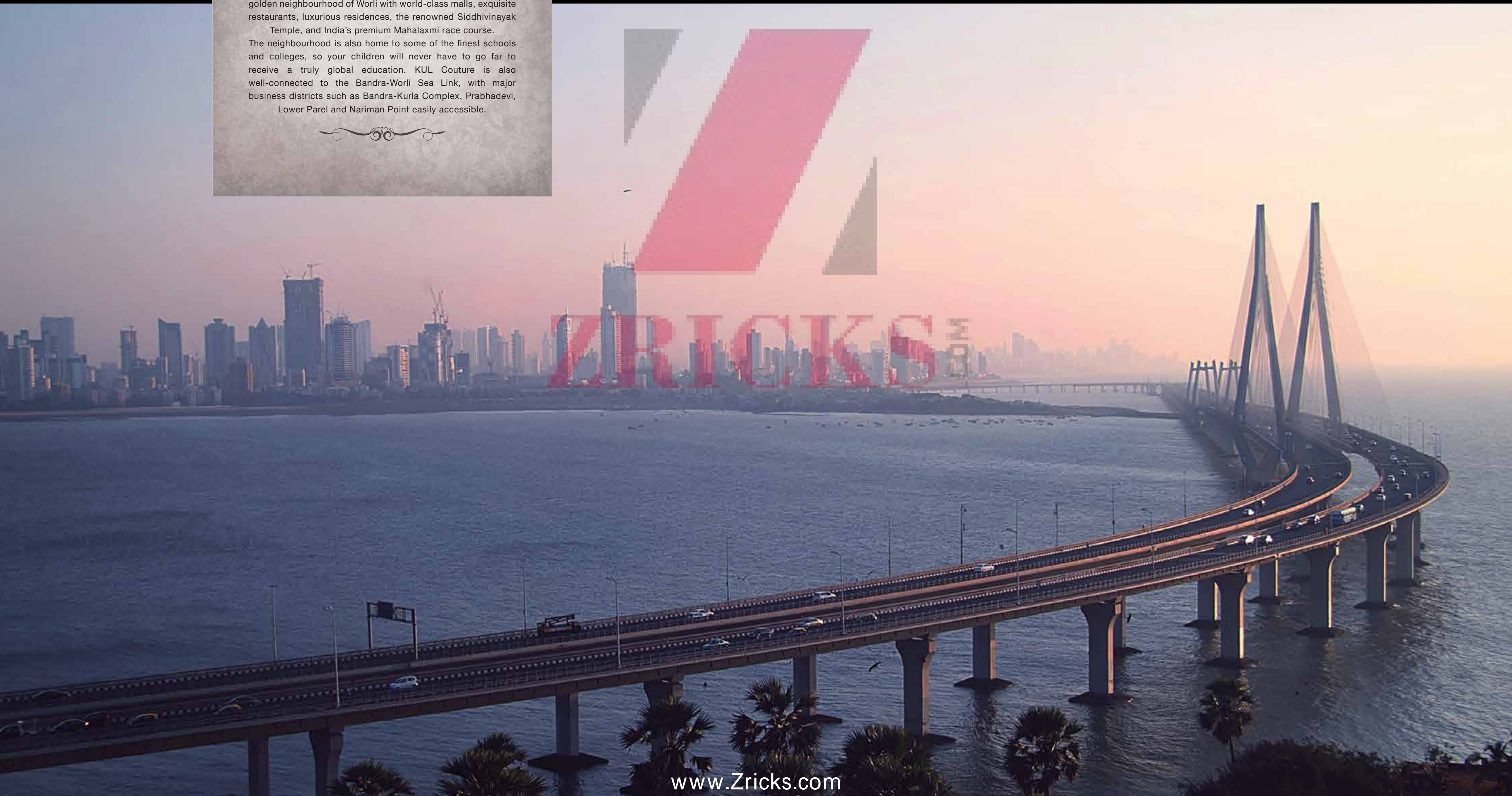



COUTURE WORLI

The limousine of buildings.



The glittering Arabian Sea competes with a dazzling tower, 12ft. height with complete building facade which offers the privileged few a bespoke lifestyle that redefines luxury. Wake up to beautiful vistas of the Arabian Sea and a steaming cup of coffee a refreshing combination to kick-start your day. Aesthetically designed by the world-renowned Hafeez Contractor, the tower soars up to a dizzying height of 400 feet to bring you closer to the galaxy. Gorgeous interiors are complemented by smart technology to make the journey to your residence smooth and pleasurable.



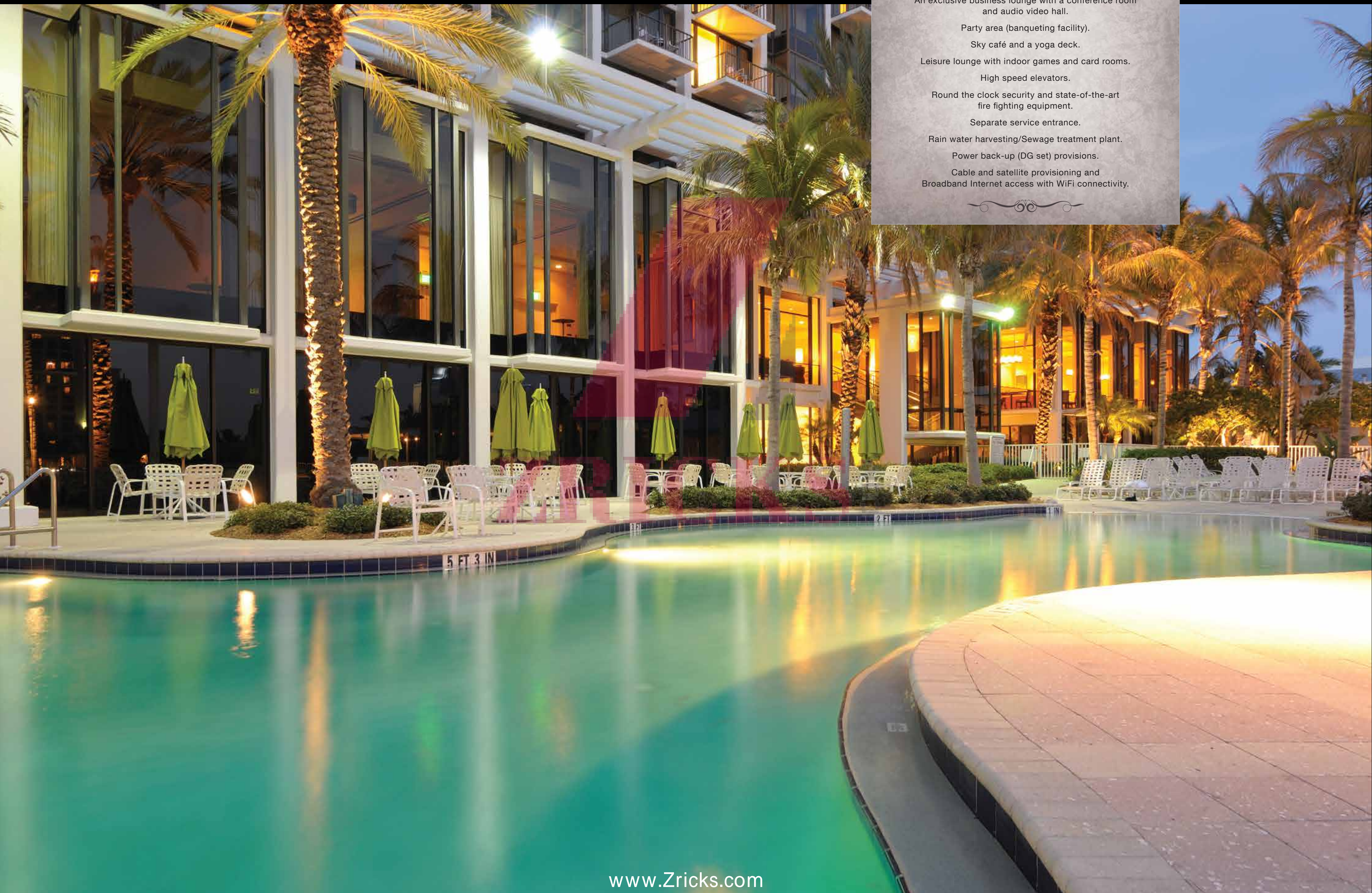

 A 1600 sq. ft. beautifully landscaped club house
 Concierge Service with Valet parking.
 Swimming pool for adults and kids, steam room,
 gymnasium, Jacuzzi.
 An exclusive business lounge with a conference room
 and audio video hall.
 Party area (banqueting facility).
 Sky café and a yoga deck.
 Leisure lounge with indoor games and card rooms.
 High speed elevators.
 Round the clock security and state-of-the-art
 fire fighting equipment.
 Separate service entrance.
 Rain water harvesting/Sewage treatment plant.
 Power back-up (DG set) provisions.
 Cable and satellite provisioning and
 Broadband Internet access with WiFi connectivity.

— — — — —
 Your heavenly abode.
 Unlike any other.
 — — — — —

In true Couture style, each residence has ample space to fit your larger-than-life personality. It is designed to offer you the freedom to choose the precise position of a wall or where the kitchen counter, which is carved out of the finest Italian marble, is placed.

Only the most premium fittings grace your residence. Marble flooring kisses your feet, wall-to-ceiling windows afford you beautiful views of the sea, and exquisite fittings in the bathroom offer a sensual experience.

Life at KUL Couture promises everything a real gentleman would expect.

As the master of your destiny, it is your birth right to choose. And you chose to blaze your own trail rather than follow another's. It is no different when it comes to your lifestyle. You make your own statements wherever you go. That is precisely why, we have handcrafted a lifestyle that is worthy of your status and personality.



— — — — —
 Make a statement
 every time you play host.
 — — — — —



— — — — —
 Your inner sanctum.
 — — — — —

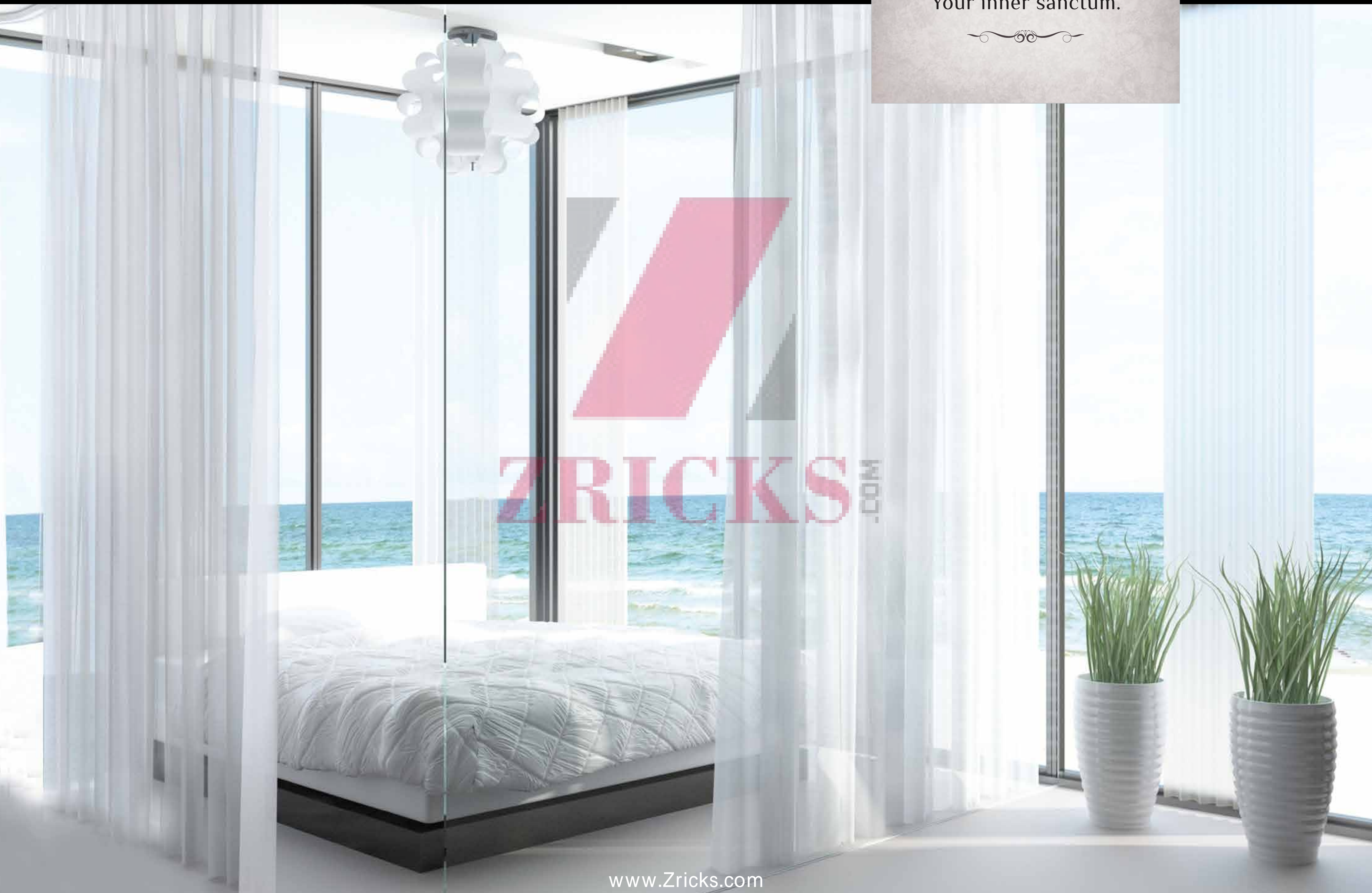

ZRICKS .COM

Every moment promises
to be a sensual experience.



Where your personal chef will be truly happy.

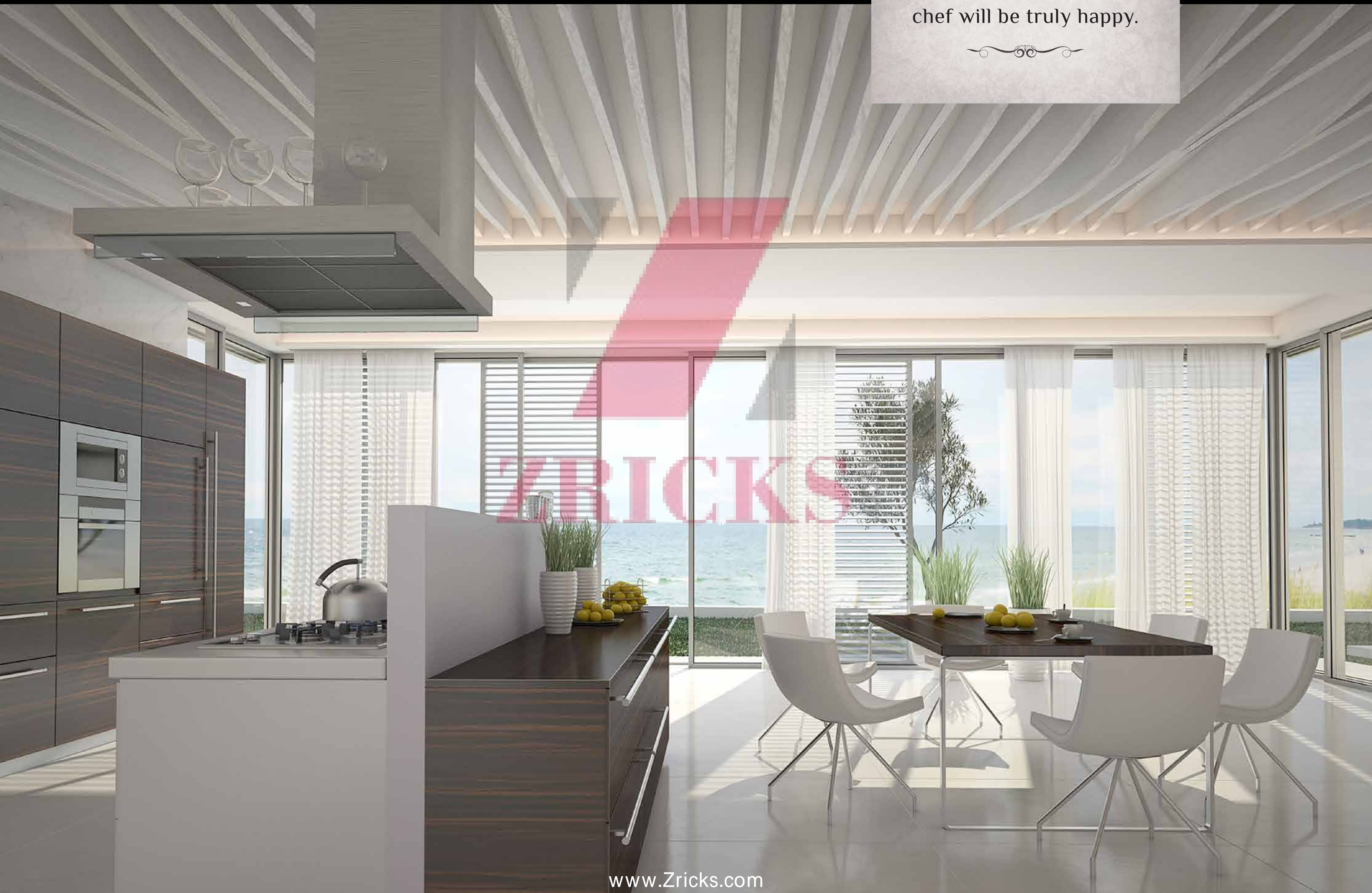

Location map



**COUTURE
WORLI**



**COUTURE
WORLI**



COUTURE WORLI

Layout plan





COUTURE WORLI

Typical floor plan

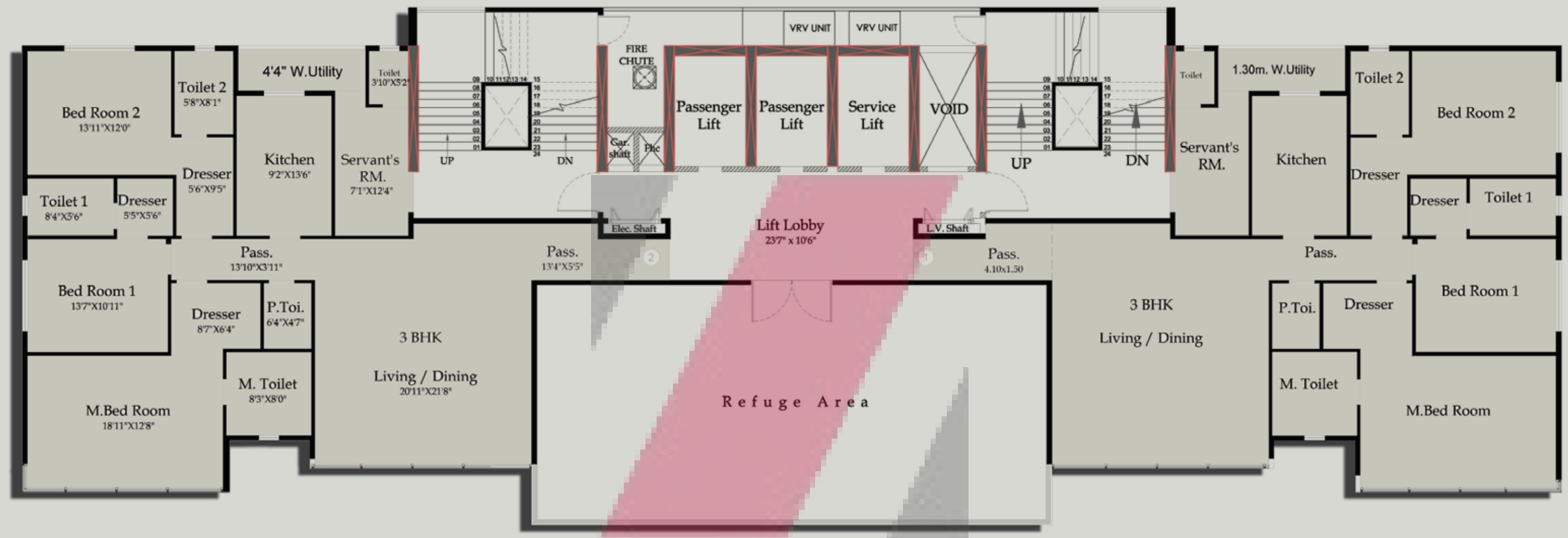

3 BHK Floor Plan

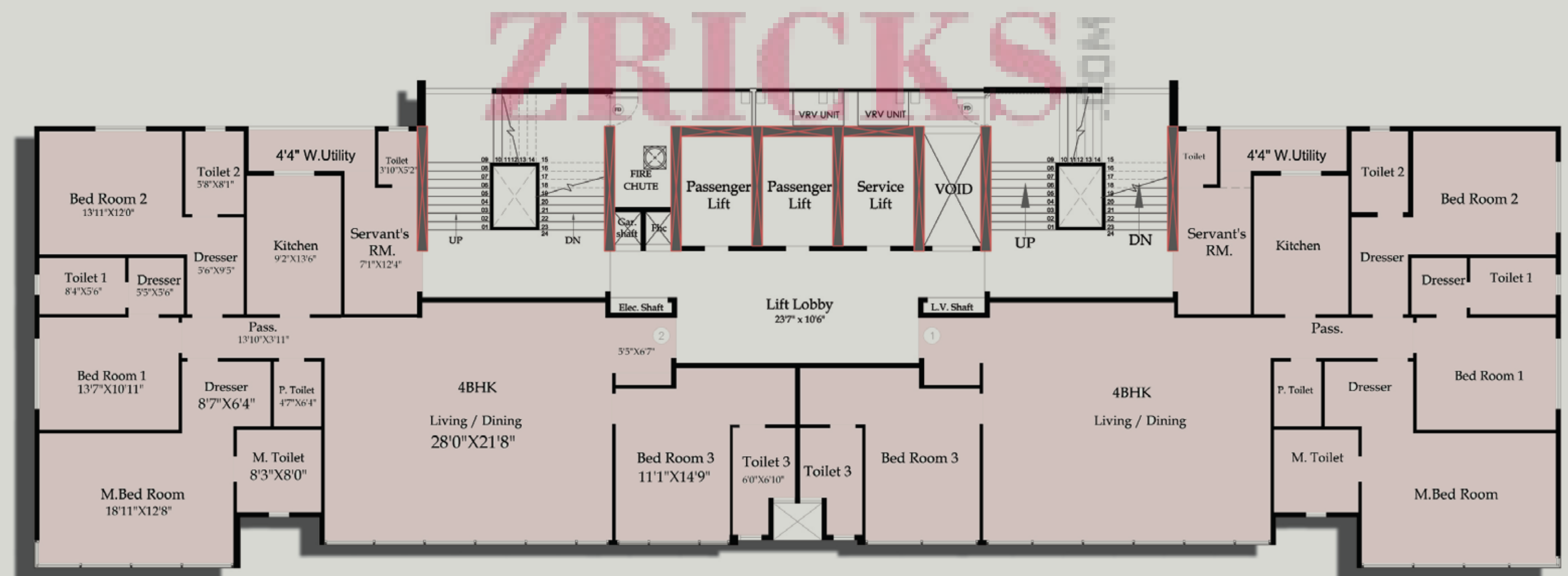

4 BHK Floor Plan



COUTURE WORLI

Floor plan



3 BHK Floor Plan - 1748 Sq. Ft.



4 BHK Floor Plan- 2158 Sq. Ft.

Our rising towers



KUL ECHELON, Tardeo, Mumbai.



KUL Elixir, Lokhandwala circle, Andheri (E), Mumbai.



KAIROS, Kalyani Nagar, Pune.



Kumar Urban Development Limited



Site Address:
Kul Couture

Century Bazaar Lane, Worli.

Mumbai Tardeo Office

Tardeo No. 7, Ground Floor,
Suryodaya Estate

Tardeo, Mumbai - 400 034

T: +91 022 4034 5353, 2352 2265

F: +91 022 2351 2397

E: sales.mumbai@kul.co.in

Pune Head Office

T: +91 (020) 40006000

F: +91 (020) 26330584

Bangaluru Branch Office

T: +91 (080) 2235 6822

F: +91 (080) 2235 6855

www.kul.co.in

